

CANOE LIVERIES

Troll Landing Canoe Rental and Campground
2260 Rifle River Trail
West Branch, MI 48661
989.345.7260

White's Canoe Livery
1243 E. Greenwood Rd.
Alger, MI 48610
989.836.2699

Parkview Acres Canoe & Boat Rental
2575 E. Rose City Rd.
Lupton, MI 48635
989.473.3444

Big Mike's Canoe Rental
Main Street
Lupton, MI 48635
989.473.2043

BAIT SHOPS

McGregor's Country Store
3980 Henderson Lake Rd.
Prescott, MI 48756
989.873.3863

J&P Sporting Goods
3275 W. M-55
West Branch, MI 48661
989.345.3744

Clear Lake Party Store
2224 Clear Lake Rd.
West Branch, MI 48661
989.345.5193

Parkview Acres
2575 E. Rose City Road
Lupton 48635
989.473.3555

Dean's Live Bait & Tackle
2260 M-30
Alger, MI 48610
989.345.3159

Zettle's Sport Center
3091 Houghton
West Branch, MI 48661
989.345.3159



The information provided in this brochure is intended for your enjoyment, it is not to be taken as a navigational guide, nor as a guarantee for catching fish. For additional information contact the West Branch/Ogemaw County Travel and Visitors Bureau at 800.755.9091 or visit www.visitwestbranch.com.

Lodging Directory



Quality Inn
Forward Conference Center
2980 Cook Rd West Branch MI 48661
989.345.3503
www.choicehotels.com

Super 8
2596 Austin's Way West Branch MI 48661
989.345.8488
www.super8.com

Tri Terrace Motel
2259 W I-75 Business Loop West Branch MI 48661
989.345.3121
www.triterracemotel.com

Welcome Motel
3308 W M-76 West Branch MI 48661
989.345.2896

Other area lodging opportunities...

Clear Lake Resort - 989.345.2459
Lake George Resort - 989.343.0856
LogHaven Bed & Breakfast - 989.685.3527
Scenic Motel - 989.685.2668

West Branch Area Chamber of Commerce and West Branch Visitors Bureau
422 West Houghton Avenue
West Branch, MI 48661
800.755.9091
www.visitwestbranch.com
www.wbacc.com

Commodity Code #80140230

FISHING AND CANOEING GUIDE WEST BRANCH OGEMAW COUNTY



800.755.9091
www.visitwestbranch.com

OGEMAW COUNTY OFFERS RIVERS, LAKES AND STREAMS FOR YOUR OUTDOOR ENJOYMENT

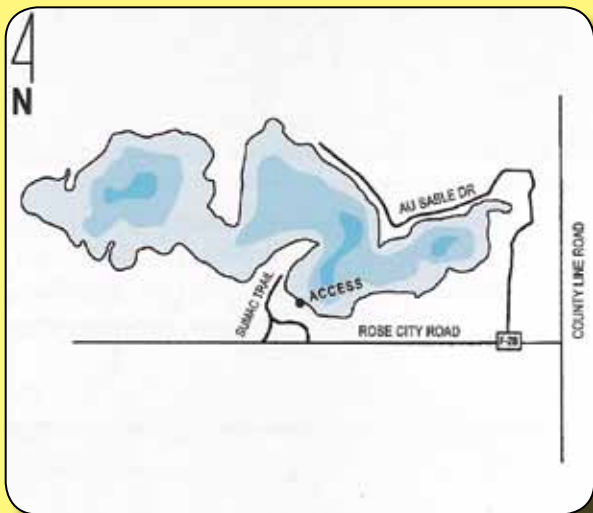

AUSABLE LAKE

AuSable Lake is located near Lupton. Take M-33 to Rose City Road (F-28) East, turn left on Sumac Trail

ACCESS SITE

Access to AuSable Lake is on Sumac Trail

TYPES OF FISH YOU WILL FIND

- Fishermen will find pike, walleye, bass, panfish, perch, crappie and bullheads plentiful in AuSable Lake.
- A small island dots the lake

BAIT SHOP

Parkview Acres
2575 E. Rose City Road
Lupton, Michigan 48635
989.473.3555

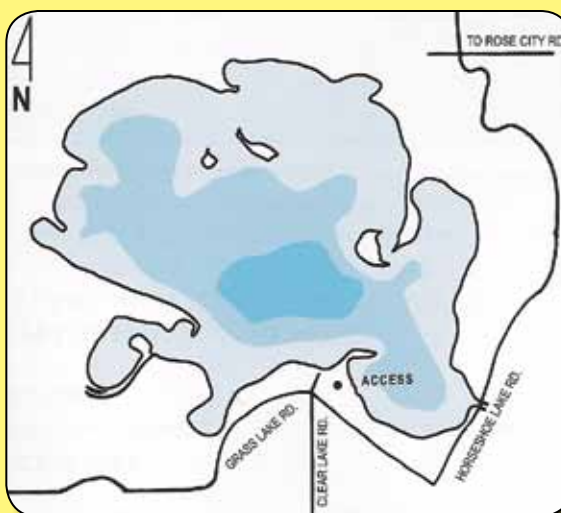

CLEAR LAKE

Clear Lake is reached by taking I-75 to Exit 212, north on Business Loop 75 to Fairview Road, then left on Clear Lake Road and right on Horseshoe Lake Road.

ACCESS SITE

Access to Clear Lake is located off Horseshoe Lake Rd.

TYPES OF FISH YOU WILL FIND

- Fishermen will find walleye, pike, bass, pan fish, perch and crappie in Clear Lake.
- Four small islands are found in this lake with a footbridge to one of them.

TIP

Try around the islands for and gravel beds during spring for bedding fish.

BAIT SHOP

Clear Lake Party Store
2224 Clear Lake Road
West Branch, Michigan 48661
989.345.7022

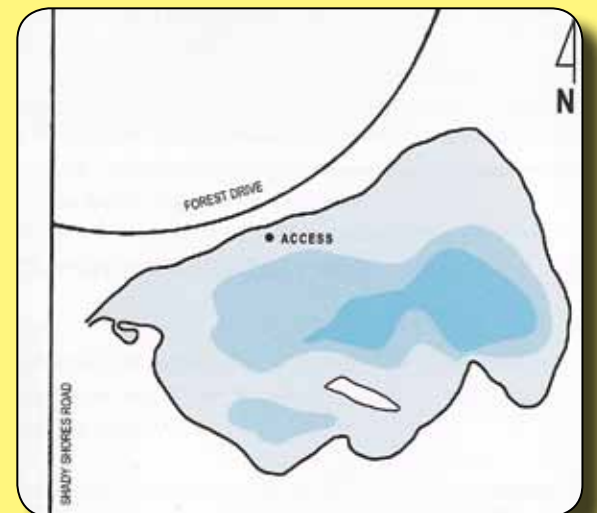

GEORGE LAKE

George Lake is reached by taking M-33, turn east on Rose City Road (F-28), right on Shady Shores Road (F-17), then left on Forest Drive.

ACCESS SITE

Access to George Lake is found on Forest Drive.

TYPES OF FISH YOU WILL FIND

- Walleye, musky, pike, bass, panfish, perch, crappie, suckers, bullheads and carp.
- Wiggins Island is found in this lake.

Tips

Crappies can be caught near the feeder creeks with minnows.

BAIT SHOP

Parkview Acres
2575 E. Rose City Road
Lupton 48635
989.473.3555

GREAT LAKES, GREAT FISHING AWAIT YOU IN OGEMAW COUNTY

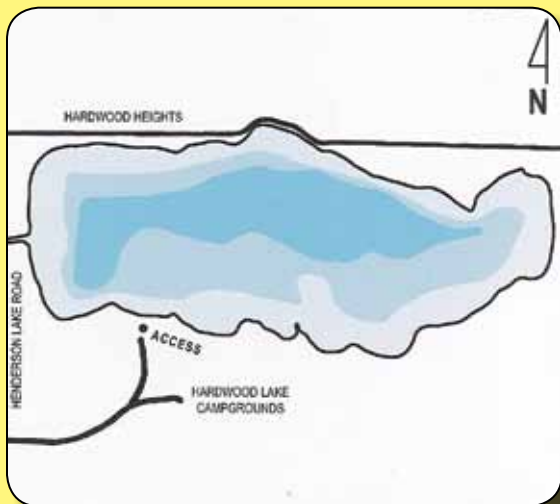

HARDWOOD LAKE

Hardwood Lake is reached by taking M-55 east to Henderson Lake Road then left to Hardwood Lake

ACCESS SITE:

Access to Hardwood Lake is found along Horseshoe Lake Road.

TYPES OF FISH YOU WILL FIND

- Fishermen will find pike, bass, pan fish, perch, crappie, suckers, bullheads, and carp

TIP

All species seem to have a pretty good size structure for the densities of the fish.

BAIT SHOP

McGregor's Country Store

3980 Henderson Lake Road
West Branch, Michigan 48661
989.873-3863

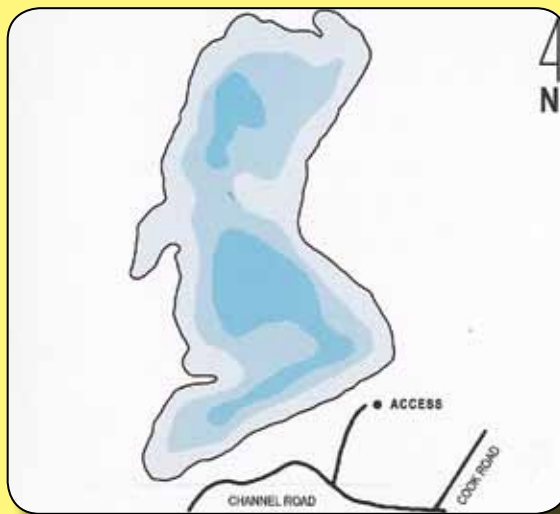

LAKE GEORGE

Lake George is reached by taking I-75 (Exit 212), then South on Cook Road to Channel Road then turn right to Lake George. Lake George is close to I-75 and close to shopping in West Branch.

ACCESS SITE

DNR access sites are easily found by following the state access site markings.

TYPES OF FISH YOU WILL FIND

- Fishermen will find rainbow trout, pike bass, panfish, perch, suckers and bullheads.
- Nice size bass and panfish.
- Bluegill are 7-8", crappie 10-12".

TIP

Look for all species to be shallow early in the season, moving deeper when the water warms.

BAIT SHOPS

J&P Sporting Goods

3275 W. M-55
West Branch, MI 48661
989.345.3744

Zettle's Sports Center

3091 Houghton Avenue
West Branch, MI 48661
989.345.3159



PEACH LAKE

Peach Lake is reached by taking M-55 to Peach Lake Road then north to Forward Street.

ACCESS SITE

Peach Lake access sites are easily found by following State DNR Access Site signs.

TYPES OF FISH YOU WILL FIND

- Fishermen will find walleye, pike, bass, panfish, crappie, suckers and carp.

Tip

Some walleye success can be found just to the right of the public access.

BAIT SHOPS

J&P Sporting Goods

3275 W. M-55
West Branch, MI 48661
989.345.3744

Zettle's Sports Center

3091 Houghton Avenue
West Branch, MI 48661
989.345.3159

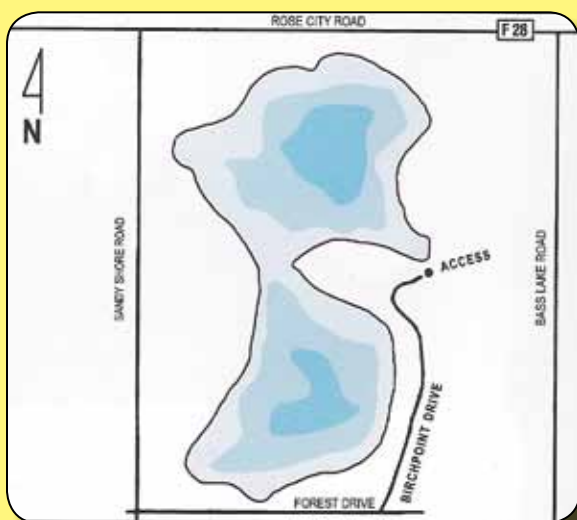

RIFLE LAKE

Rifle Lake is reached by taking M-33 East on Rose City Road (F-28), right on Shady Shores Road (F-17), then left on Forest Drive to Birchpoint Drive.

ACCESS SITE

DNR access to Rifle Lake is found along Birchpoint Drive.

TYPES OF FISH YOU WILL FIND

- Fishermen will find walleye, pike, bass, pan fish, perch and crappie.
- Rifle Lake is a quiet lake with good fishing

BAIT SHOP

Parkview Acres

2575 E. Rose City Road
Lupton 48635
989.473-3555

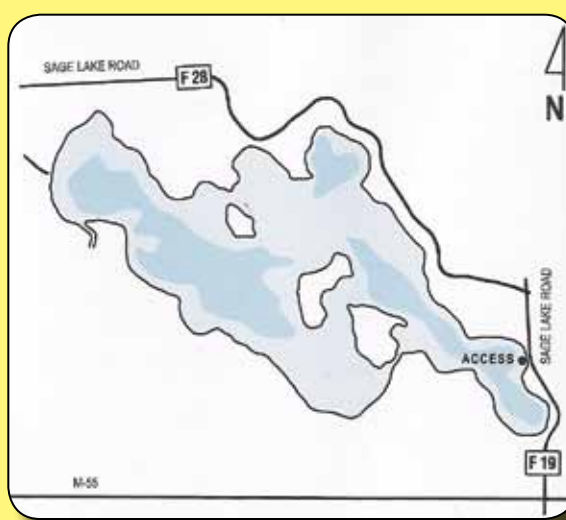

SAGE LAKE

Sage Lake is reached by taking M-55 East from West Branch to Sage Lake Road (F-19) North to Sage Lake.

ACCESS SITE

DNR access sites to Sage Lake are found along Sage Lake Road

TYPES OF FISH YOU WILL FIND

- Fishermen will find pike, bass, pan fish, perch, crappie, bullheads, walleye and bowfish.
- Sage Lake is the largest lake in Ogemaw County, featuring three islands (Happy, Second, and Berans Island)

BAIT SHOP

Parkview Acres

2575 E. Rose City Road
Lupton 48635
989.473.3555

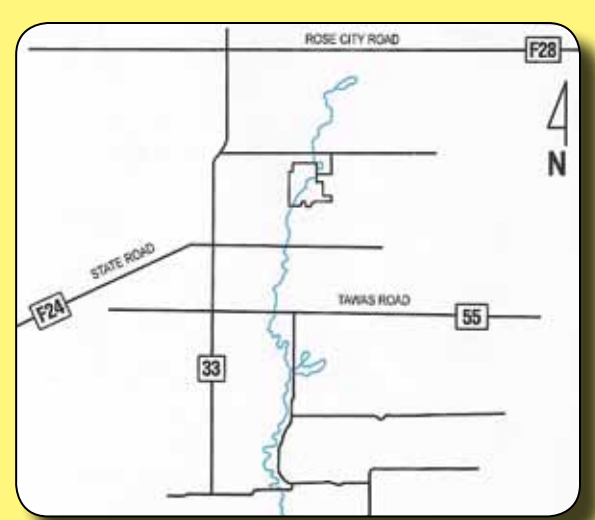

RIFLE RIVER

The Rifle River flows through Ogemaw County and is the best know of the rivers in the county. Canoeing, tubing, fishing and camping are all part of the river system.

ACCESS SITE

DNR access sites are located all along the Rifle River. Following the Rifle River Trail will provide easiest access.

TYPES OF FISH YOU WILL FIND

- Fishermen will find brown trout, rainbow trout, steelhead, salmon and suckers.
- North of M-55 is best for brown trout, while South of M-55 is best for steelhead
- The Rifle River originates at Devoe Lake in Ogemaw County at the Rifle River Recreation Area.

BAIT SHOPS

Bait shops are located along the river as well as many canoe liveries. Check with the Chamber of Commerce for more details about this river recreation opportunity.